

Latimea danturii "h" per modul: 40 mm

Latimea totala "H" per modul: 60 mm

Unghi de angrenare: 20°

Material: otel C45E-UNI EN 10083-1

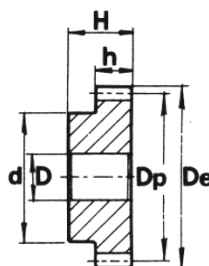
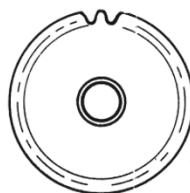

Z (numar de dinti)	Cod	De (mm)	Dp (mm)	d (mm)	D (mm)
12	PM 31012	56	48	35	14
13	PM 31013	60	52	40	14
14	PM 31014	64	56	45	14
15	PM 31015	68	60	45	14
16	PM 31016	72	64	50	15
17	PM 31017	76	68	50	15
18	PM 31018	80	72	50	15
19	PM 31019	84	76	60	15
20	PM 31020	88	80	60	15
21	PM 31021	92	84	70	20
22	PM 31022	96	88	70	20
23	PM 31023	100	92	75	20
24	PM 31024	104	96	75	20
25	PM 31025	108	100	75	20
26	PM 31026	112	104	75	20
27	PM 31027	116	108	75	20
28	PM 31028	120	112	75	20
29	PM 31029	124	116	75	20
30	PM 31030	128	120	75	20
31	PM 31031	132	124	80	20
32	PM 31032	136	128	80	20
33	PM 31033	140	132	80	20
34	PM 31034	144	136	80	20
35	PM 31035	148	140	80	20
36	PM 31036	152	144	80	20
37	PM 31037	156	148	80	20
38	PM 31038	160	152	80	25
39	PM 31039	164	156	80	25
40	PM 31040	168	160	80	25
45	PM 31045	188	180	80	25
48	PM 31048	200	192	80	25
50	PM 31050	208	200	80	25
60	PM 31060	248	240	100	25
65	PM 31065	268	260	100	25